



KONGSBERG
AUTOMOTIVE

EH-1000

ELECTRONIC THROTTLE CONTROL



AT A GLANCE

- Electronic lever control with friction hold
- Can be utilized in applications for Electronic Fuel Injection (EFI) and Full Electric
- Patented vSENSE™ non-contact sensor provides position sensing and switching accuracy and reliability
- Innovative modular design allows for installation in a wide range of applications and configurations
- Robust design tested for Outdoor Power Equipment (OPE) environments and vehicles
- Adjustable actuating force
- Analog and PWM sensors available

Product Description

The EH-1000 Electronic Throttle Control is the latest control to utilize Kongsberg Automotive's leading vSense sensor technology. Designed for the rigors of OPE applications, construction, agricultural and industrial vehicle control, the EH-1000 is intended for use with electronic engines as a hand engine idle speed and position control.

Designed to provide ease of installation and mounting, this product is adaptable for a wide range of electronic control applications requiring a robust, durable design.

The compact, fully sealed unit offers extended service life in the harshest environments. With multiple sensor output options, the vSense non-contact sensor may be configured to meet the customer's exact requirements.

This device can be used as a standalone product or it can be used in conjunction with other Kongsberg Automotive products to create a complete control system for virtually any type of OPE application.

Contact:

United States: Kongsberg Automotive, 300 South Cochran St., Willis 77378, TX, United States
Europe: Kongsberg Interior Systems Kft., Bajcsy-Zs. u. 201/D, Siófok, 8600 Somogy, Hungary
China: Lone Star, 2nd Building, 777 Yuandong Rd, Nanqiao Town, Fengxian District 201401, China
E-mail address: ope.inquiries@ka-group.com (common to all sites)

Product Specifications

ETC parameters

ETC parameters	Specifications
Operating Voltage:	Analog 5V+/- 0.5V PWM 7.5V to 32V
Product Life (Full Travel Cycles):	10.000 cycles
Output Range (programmable) within:	Minimum > 7% of supply voltage Maximum < 90% of supply voltage
Travel Angle Range:	70° (standard)
Operating Temperatures:	-40°C to +85°C (-40°F to + 185°F)
Storage Temperature:	-54°C to +85°C (-165,2°F to +185°F)
Salt Spray:	96 Hours
Solid Objects and Water Ingress:	Sensor IP67 rated
Connector:	Integrated Metri Pack
Specification Compliances:	ASTMB633; ASTM B117-97, SAEJ726, SAEJ1843, SAEJ1455, KA PS-462, PS-00522
Engine Compability:	Electronic Fuel Injection (EFI) and Full Electric
Engine Input Options:	Single Analog, Dual Analog, Single Analog w/IVS, PWM and CANbus

Features and benefits

- Industry leading and patented vSense™ Hall effect non-contact sensor provides accuracy and reliability
- Analog and PWM sensors available
- Robust, durable design
- Factory set friction mechanism holds position resistant to vibration
- Adjustable actuating force
- Easy installation
- Available with standard knobs and levers
- Dynamic IP67 sensor
- Optional outputs available
- Can be considered for extreme environmental conditions
- Cycle life provides minimal maintenance costs

Mounting configuration

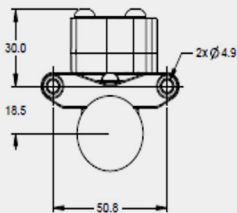

Screw bosses are designed to be utilized with self-tapping Plastite screws.

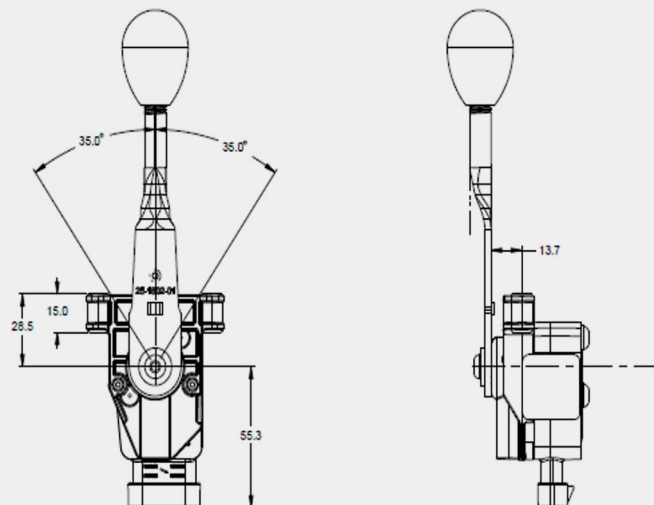

Lever/knob styling options



Supplied installed or bulk.