

CSBW

COMPACT STEER BY WIRE UNIT



AT A GLANCE

- > A COMPACT, LIGHTWEIGHT, ROTARY CONTROL, SUITABLE FOR ANY OFF HIGHWAY VEHICLE APPLICATION
- > DESIGNED FOR EASY STEER BY WIRE FUNCTION
- > EASY MOUNTING
- > CONFIGURED FOR CANBUS J1939 OUTPUT

PRODUCT DESCRIPTION

The CSBW – Compact Steer by Wire Unit is intended for use on any application where an electronic steering function is required. Output is configured to SAE J1939 protocol, but could be configured for a custom requirement.





PRODUCT SPECIFICATIONS

PARAMETERS	SPECIFICATIONS
OPERATING TEMPERATURE	-40°C TO +85°C
IP RATING	IP67
CANBUS PROTOCOL	SAE J1939

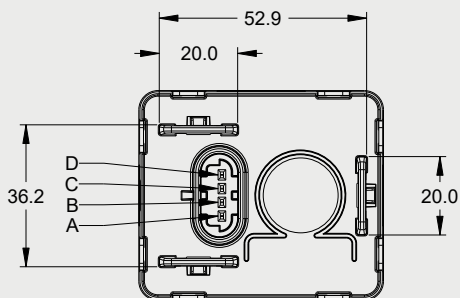
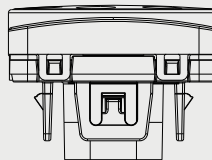
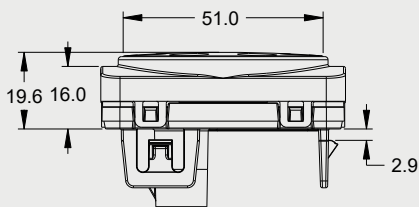
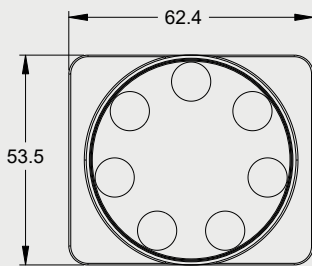

FEATURES

- > CANBUS SAE J1939 OUTPUT
- > 4 PIN METRIPACK 150 INTEGRATED CONNECTOR

OPTIONS

- > OUTPUT CAN BE CONFIGURED TO CUSTOM SPECIFICATION, IF REQUIRED